

Item
M2200 MASS™ WALL STORAGE CABINET
with FlexLok™ Door

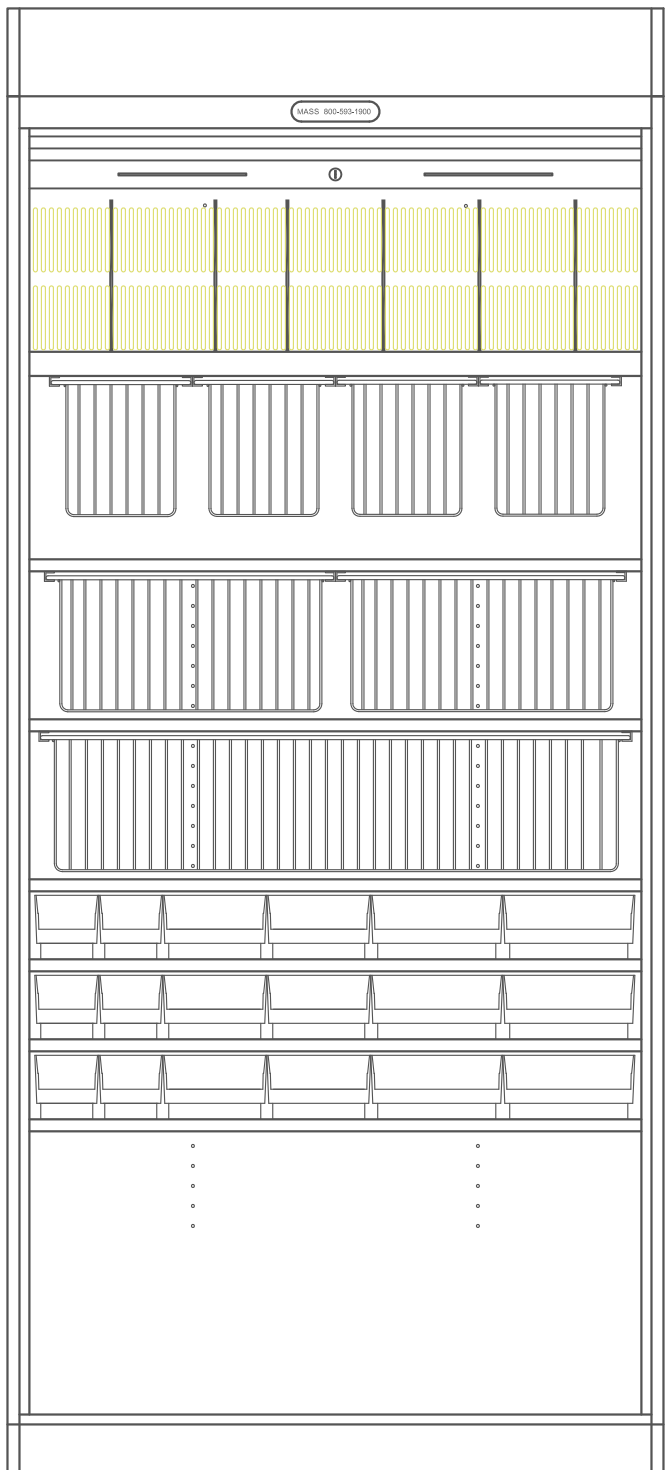

FlexLok™ Door
with Keyed Lock

Upper Fixed
SlotShelf™ with 6
Adjustable Dividers

9" Quarter Size Wire
Baskets (M2239Q)

9" Half Size Wire
Baskets (M2239H)

9" Full Size Wire
Basket (M2239F)

Standard Blue Bin
Module (M2225)

Standard Blue Bin
Module (M2225)

Standard Blue Bin
Module (M2225)

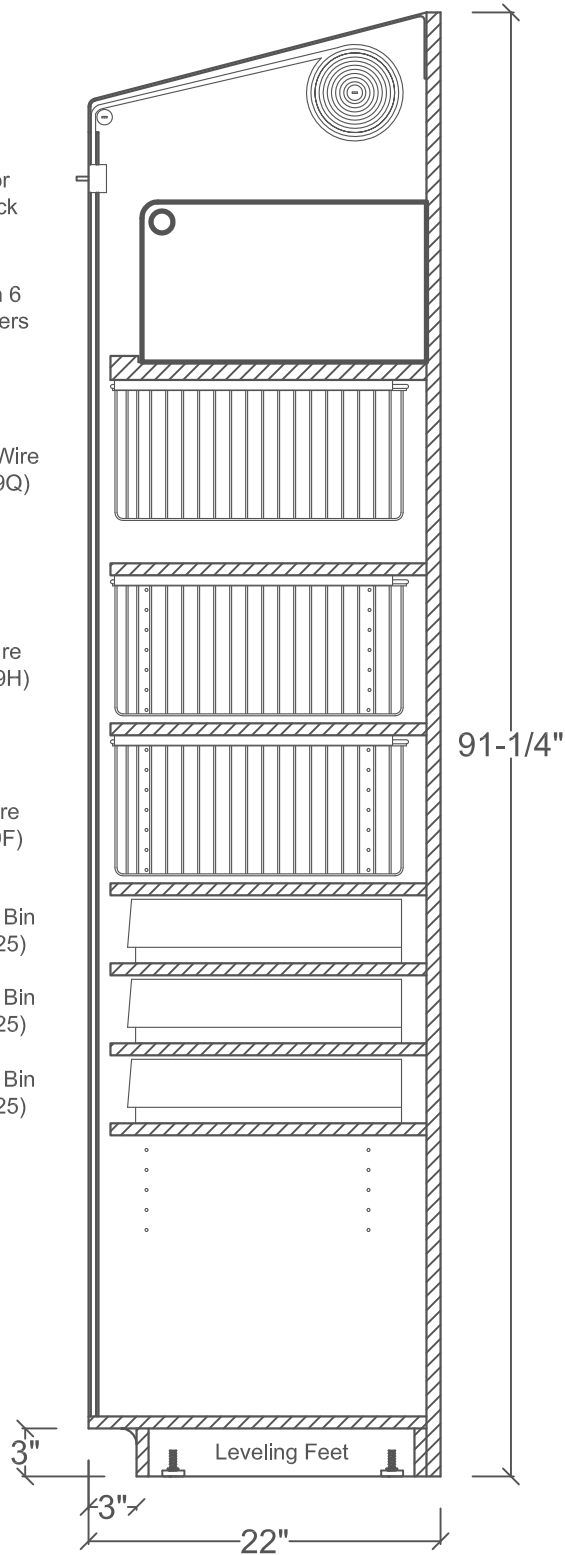

91-1/4"

3"

3"

Leveling Feet

22"

41"

MASS Medical Storage
 14560 West 99th St.
 Lenexa, KS 66215 USA
 Fax 913-438-2275
 Toll Free 1-800-593-1900

Customer:

Quote#:

Date:

Rev #:

Rev Date:

Drawn By: BMF

MASS Apvd:

Customer Apvd: