

1. PREPARE

- Turn compressor **off**
- Unplug cabinet
- Remove top cap

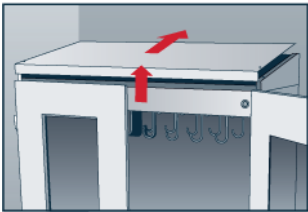

To access the mist filter, remove the **two screws** located on cabinet top, then lift up and push back top cap to remove.

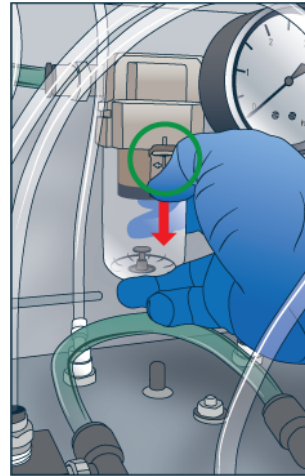

2. UNLOCK FILTER CAP

- Press down on **tab**

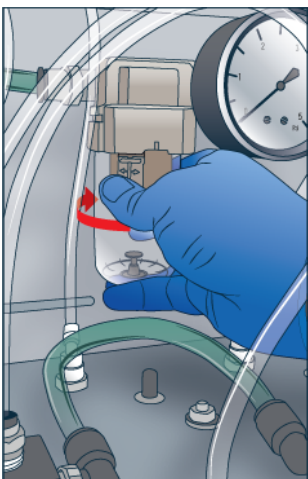

3. REMOVE FILTER CAP

- Turn clockwise to open

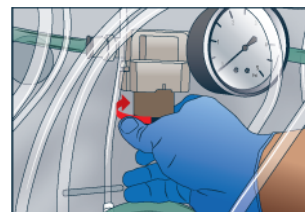

4. REMOVE AND REPLACE FILTER

- Turn clockwise to remove old filter
- Turn counter-clockwise to install new filter

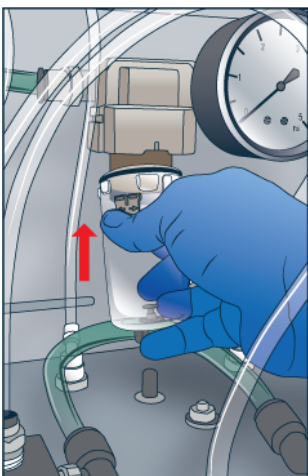
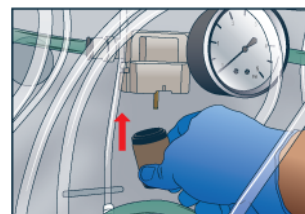

5. FINISHING TOUCHES

- Replace filter cap
- Turn counter-clockwise to close
- Plug in cabinet
- Turn compressor unit on
- Replace cabinet top cap

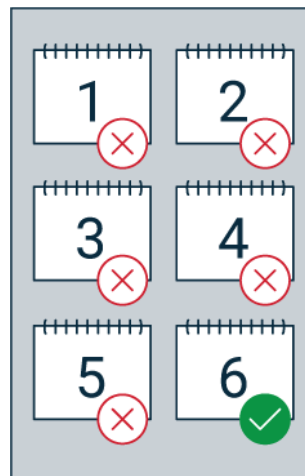

REPLACEMENT FILTERS

- MASS™ truAIR™ mist filters should be changed every six months
- New filters can be ordered from MASS™ Medical Storage
- Contact our service department at 800.593.1900 with any questions

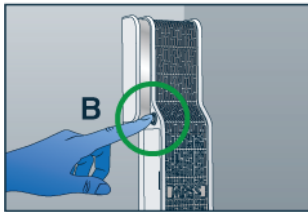
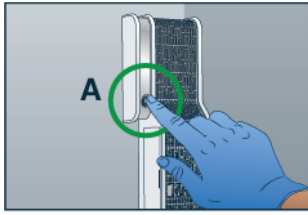

1. PREPARE

- Turn the truHEPA™ fan off
- **Power button** is in location A or B depending upon part revision
- Unplug cart/cabinet

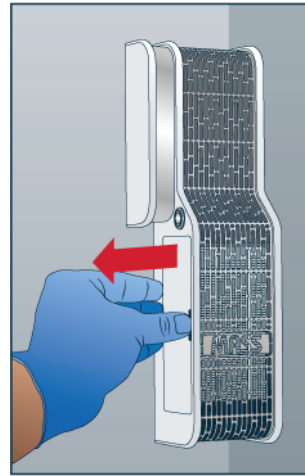

2. REMOVE OLD FILTER

- Slide the old filter out to the left
- Make sure to slide the filter straight out, using the cabinet's back wall as a guide

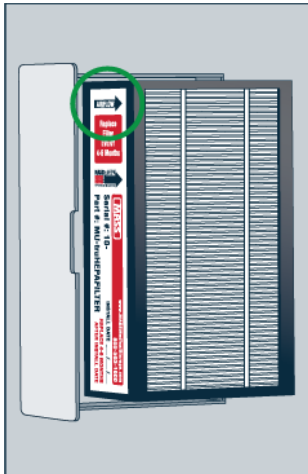

3. INSERT NEW FILTER INTO HOLDER

- Place the new truHEPA™ filter between the arms of the filter holder
- The **AIRFLOW** arrow should point into the cabinet, away from the back wall

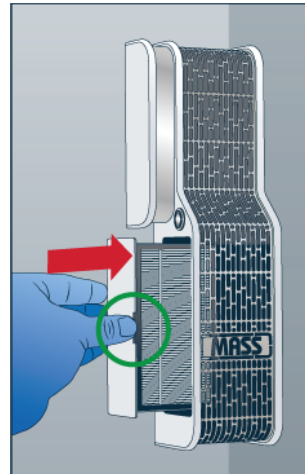

4. REINSERT FILTER HOLDER

- Insert the filter holder's arms into the grooves of the truHEPA™ unit
- The **thumb notch** should be away from the wall
- Slide the filter holder to the right, until it is flush with the unit

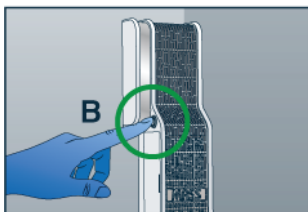
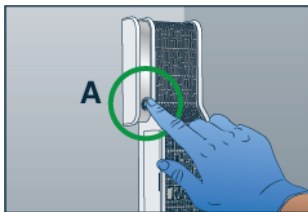

5. FINISHING TOUCHES

- Plug cabinet/cart back into electrical outlet
- Press the **power button** to turn the fan on again
- Power button will glow when unit is on

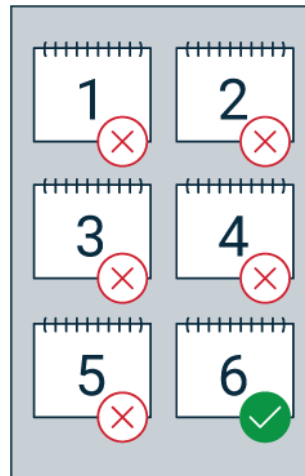

REPLACEMENT FILTERS

- truHEPA™ filters should be changed every four to six months
- New filters can be ordered from MASS™ Medical Storage
- Contact our service department at 800.593.1900 with any questions