

### 1. PREPARE

- Turn the truHEPA™ fan off
- **Power button** is in location A or B depending upon part revision
- Unplug cart/cabinet

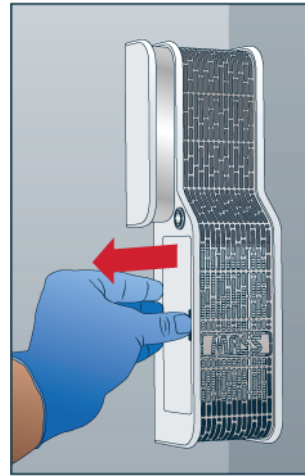

### 2. REMOVE OLD FILTER

- Slide the old filter out to the left
- Make sure to slide the filter straight out, using the cabinet's back wall as a guide

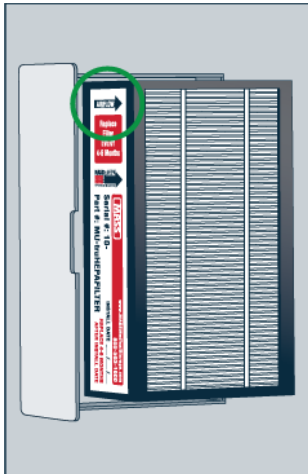

### 3. INSERT NEW FILTER INTO HOLDER

- Place the new truHEPA™ filter between the arms of the filter holder
- The **AIRFLOW** arrow should point into the cabinet, away from the back wall

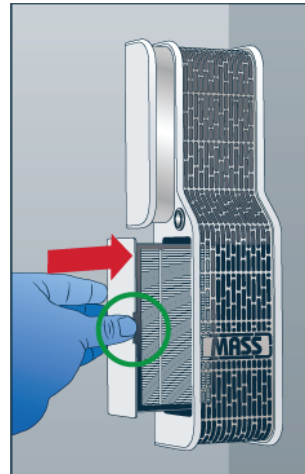

### 4. REINSERT FILTER HOLDER

- Insert the filter holder's arms into the grooves of the truHEPA™ unit
- The **thumb notch** should be away from the wall
- Slide the filter holder to the right, until it is flush with the unit

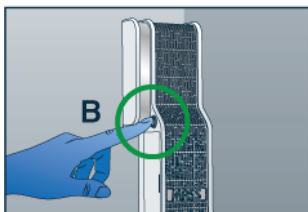
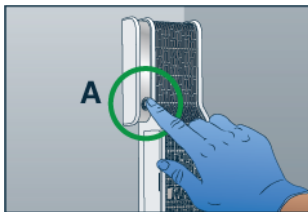

### 5. FINISHING TOUCHES

- Plug cabinet/cart back into electrical outlet
- Press the **power button** to turn the fan on again
- Power button will glow when unit is on

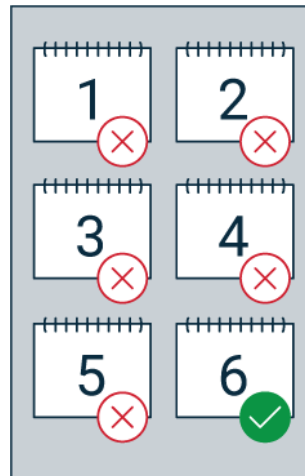

### REPLACEMENT FILTERS

- truHEPA™ filters should be changed every four to six months
- New filters can be ordered from MASS™ Medical Storage
- Contact our service department at 800.593.1900 with any questions